

AUTODRYER

Smarter, Stronger, Lasts Longer ... up to 70% more energy efficient



Redwood Tree Car wash - Ukiah CA

AutoDryer™ is a car wash drying system that's ultra-durable and remarkably energy efficient. Unlike traditional systems that use plastic dryer housings, AutoDryer™ features solid cast aluminum housings. This new design outlasts and outperforms the competition. In addition, the AutoDryer™ system can be equipped with DryerIQ™, an advanced power management Motor Control Center that ensures maximum energy efficiency and maximum savings.

AutoDryer™ is taking the car wash industry by storm, leaving traditional energy hogging dryer systems in the dust ... and slashing operating costs by an average of up to 70%.

888-628-8682

email: sales@autodryerinc.com • www.autodryerinc.com

AutoDryer™ Components

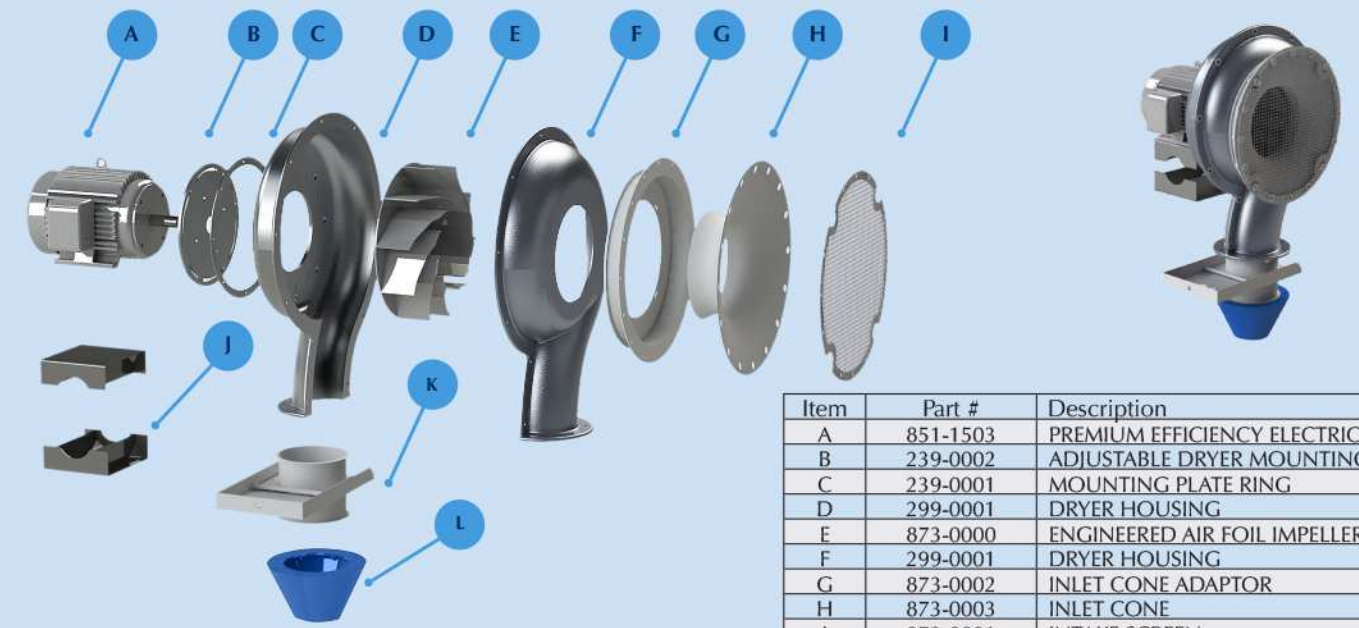

Item	Part #	Description
A	851-1503	PREMIUM EFFICIENCY ELECTRIC MOTOR
B	239-0002	ADJUSTABLE DRYER MOUNTING PLATE
C	239-0001	MOUNTING PLATE RING
D	299-0001	DRYER HOUSING
E	873-0000	ENGINEERED AIR FOIL IMPELLER ASSEMBLY
F	299-0001	DRYER HOUSING
G	873-0002	INLET CONE ADAPTOR
H	873-0003	INLET CONE
I	873-0001	INTAKE SCREEN
J	799-0027	UNIVERSAL MOUNT BRACKET FOR 4 1/2IN PIPE
K	842-8000	AIR BRAKE ASSEMBLY
L	885-0008	DRYER NOZZLE

AutoDryer™ Arches



Part #	Description	ITEM #
238-0101	DRYER SUB ASSEMBLY SYSTEM X1	1
238-0501	DRYER SUB ASSEMBLY SYSTEM X5	2
789-0008	CROSSBAR 4.5IN FULL RADIUS	3
799-0028	CLAMP HALF PIP 4.5IN X2	4

Nozzles

Round nozzles create higher air pressure and concentrate air velocity to quickly disperse water over horizontal areas.

A	Dryer Nozzle 6"
B	Dryer Nozzle 8"
C	Dryer Nozzle 12"
D	Dryer Nozzle 16"
E	Dryer Nozzle 20"



Custom nozzles and manifolds available upon request.



888.628.8682 • email: sales@autodryerinc.com • www.autodryerinc.com

AutoDryer™ Features

The AutoDryer™ system dries vehicles very efficiently. The air producer housing is cast aluminum which is rigid, crack-resistant and impervious to the elements. Its unique engineered casting design incorporates a scrolled housing that produces high CFM and air pressure velocities to

maximize drying performance. Our backward curved Air Foil impellers are manufactured to strict standards. All AutoDryer™ systems are built on a structurally sound air producer frame made of aluminum, stainless steel or coated carbon steel. Add DryerIQ™ to maximize performance and efficiency.

Features	Benefits
Solid cast aluminum housings form a rigid no-flex design	No "Oil-Canning", rigid design holds its shape and resists cracking for dramatically longer equipment life
Larger, more efficient impeller blades	Greater pressure (Rigid housing also allows for increased rpm over 3600)
Customizable layout	Air producers can be arranged to your exact specifications, units are interchangeable for left or right mounting
Customizable color	Match your wash's color scheme
High quality components	Impellers, air actuators, fasteners and hardware are designed for maximum reliability and durability
Arch assembly available in several styles	Choose a material that fits your needs: steel (with Endura paint), stainless steel, or aluminum
Nozzles are easy to change and available in 5 styles	Engineered and Certified Air Foil Impellers Create the ideal air pressure and airflow where you need it

DryerIQ™

The DryerIQ™ Difference

Every AutoDryer™ system can be equipped with DryerIQ™. This proprietary power management program features highly specialized computer software and a dynamic variable frequency drive (VFD). DryerIQ™ effectively matches the RPMs of the air producer's motor to match the load. DryerIQ™ does this by managing the RPMs – not just restricting air flow. This is a significant departure from traditional air producer models which simply close a valve, or air brake, between cars. Closing an air brake reduces the load on a motor – BUT that motor is still running full throttle and spinning its blades at max RPMs. It does very little to combat the wear and tear on equipment, and fails to capture the remarkable energy savings made possible by DryerIQ™. With DryerIQ the Dryer can also be accelerated over 3600 rpm to achieve even greater airflow and pressure if needed. (See below.)

Example: 208V Dryer Motor

	Full Throttle	Air Brake Closed (But Still Full Throttle)	Air Brake Closed with DryerIQ™
Flow in AMPS	48 Amps	24 Amps	12 Amps
RPMs – Hz (Hz x sec=RPM)	60 Hz	60 Hz	40 Hz
Kilowatts (\$ energy \$)	11 kW	9 kW	2 kW

Auto Dryer can maintain 60 HZ even when only 50 HZ power is available

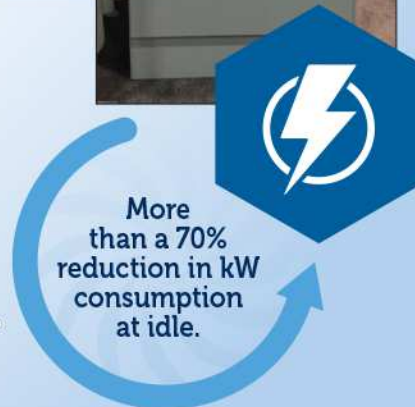

AutoDryer™ Specifications

15Hp Blower Specifications		
Velocity: 185 MPH Air Speed - Air Flow: 4950 SCFM		
Voltage	Hertz	Electrical
208/230/460 V	60 Hz	3 Phase
575V	60 Hz	3 Phase
415V	50 Hz	3 Phase
380V	50 Hz	3 Phase

Decibel Levels (15Hp)	
10 feet	85 dBA
20 feet	79 dBA
50 feet	72 dBA



- One arch with three air producers requires 38 inches (top) x 51 inches (bottom) of wash tunnel length.
- Each additional arch with air producers requires an additional 60 inches minimum of wash tunnel length.
- Models with side air producers require 160 inches minimum of wash tunnel width.
- Models with top air producers ONLY require 158 inches minimum of wash tunnel width.
- Models with side air producers ONLY require 120 inches minimum of wash tunnel height.
- Models with top air producers require 136 inches minimum of wash tunnel height.

AutoDryer™ Performance (15HP)

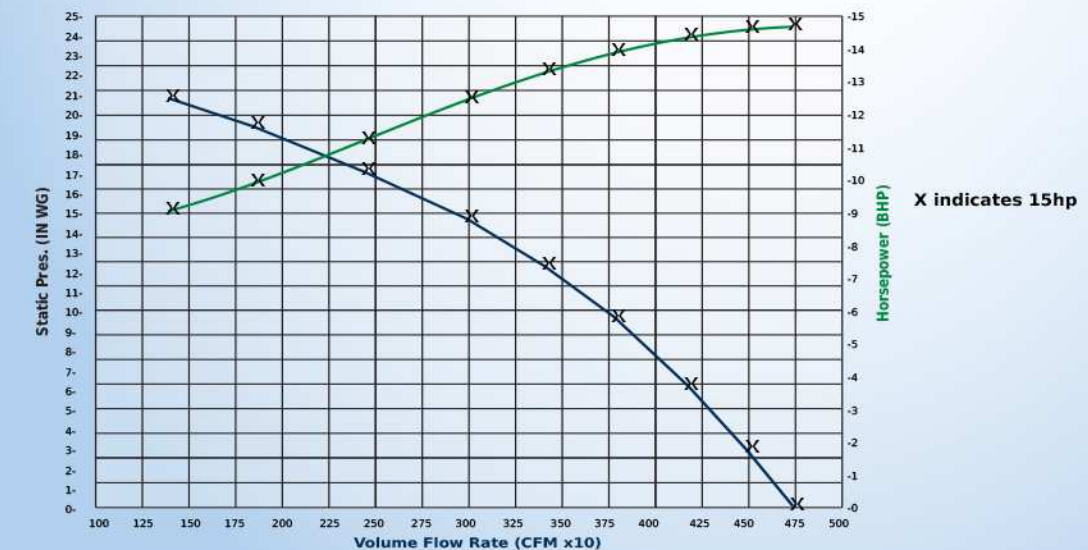

Auto Dryer is the only Dryer to offer certified blower curves